

Description:

The Orbis Adaptor allows Orbis detectors to be fitted to an existing Series 60 base. No rewiring of the existing fire system is required.

When an Orbis detector head is fitted into the adaptor, it forms a detector/adaptor assembly. To lock this assembly to the existing base, the tab shown in Figure 1 should be removed.

General Criteria

- The Orbis Adaptor cannot be fitted to a Series 60 base without first having an Orbis detector head fitted to the adaptor.
- The Orbis Adaptor does not have a continuity link.

Installation:

Observe anti-static precautions at all times

1. Isolate or power down the circuit or zone to which the Series 60 to be changed are fitted.
2. Remove the Series 60 detector from its base, unlocking it with a 1.5mm AF hex driver if required.
3. Fit an Orbis detector to the adaptor to create a detector / adaptor assembly.
4. The assembly can be locked to the existing base by means of the removable tab on the underside of the assembly as shown in Figure 1.
5. Fit the assembly to the Series 60 base.
6. De-isolate or re-power the circuit or zone.
7. Commission the detector in accordance with any local code.

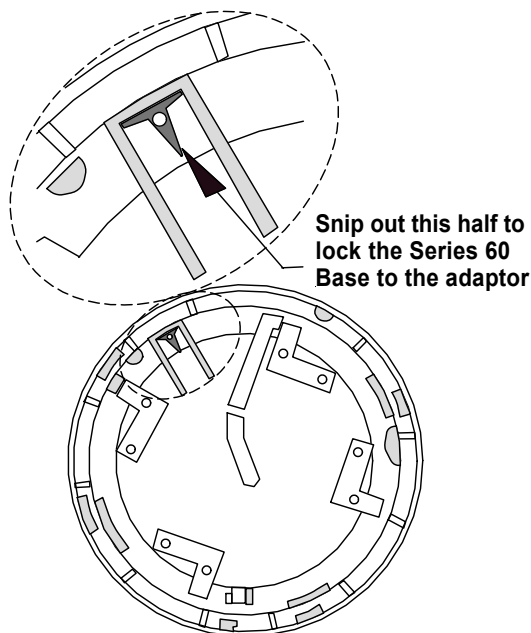

Figure 1:

Releasing the assembly from a Series 60 Base

1. Twist the assembly anticlockwise to release it from the base.
2. If the assembly is locked to the Series 60 base, unlock it by locating the slot in the adaptor moulding as shown in Figure 2. Then, using a small screwdriver in the slot, gently lever the locking mechanism toward the Series 60 base whilst twisting the assembly anticlockwise.

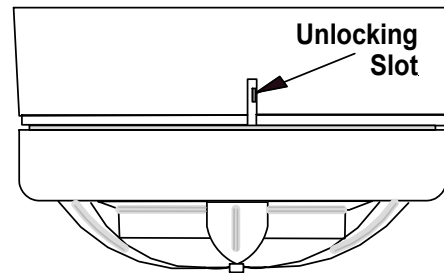

Figure 2:

Unlocking the Detector Head from the Adaptor

1. Remove the assembly from the Series 60 base (as described above).
2. Locate the locking tab on the back of the adaptor shown in Figure 3.
3. Using a small, flat-head screwdriver, gently lift up the locking tab and twist the adaptor in an anti-clockwise direction to separate the detector head and adaptor. (See Figure 3).

Note: Details of the features of the Orbis Detector can be found in the installation guide.

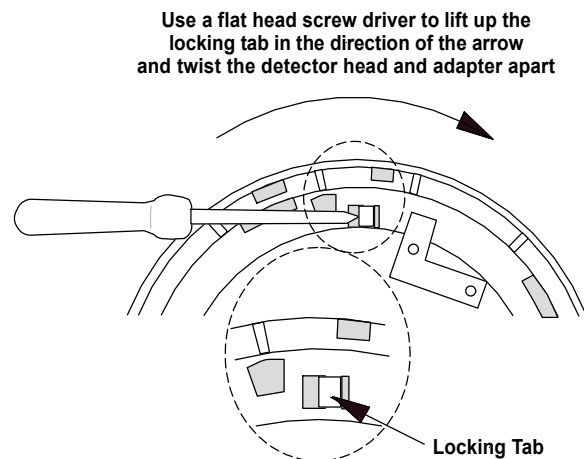

Figure 3: