

**Description:**

The ACP-03 is a surface or flush mounting break glass type manual call point (MCP). The MCP has a two stage alarm activation to comply with the requirements of NZS4512, the glass element must be broken and then the toggle switch activated.

**Features**

- Two stage activation
- Large termination area
- Double wire protected terminals

Specification	
<b>Switch Type:</b>	Single Pole changeover toggle switch
<b>Contact rating</b>	2A @ 250 VAC 2A @ 28 VDC
<b>Dimensions:</b>	
Surface	130h x 120w x 55d mm
Flush	130h x 120w x 27d mm
<b>Approvals</b>	NZS4512

**Testing of MCP Operation**

1. Isolate the fire system from calling the fire brigade before testing
2. Remove the front cover and glass element
3. Activate the alarm switch, wait for the alarm to be registered on the Fire Alarm Control Panel
4. Deactivate the alarm switch, refit the glass element and front cover

**Surface Mount**

Locate the back box over a flat surface, securing with at least two (2) screws tightened evenly to prevent distortion.

**Flush Mount**

Locate the back box inside the wall cavity with the front edge level with the wall surface.

**Cable Entries**

One (1) 15mm cable entry is provided.

**Installation and Terminating**

1. Remove the two (2) securing screws from the front of MCP and carefully lift off cover. Be mindful of the frangible glass.
2. Remove the four (4) securing screws from the inside assembly of the MCP and carefully lift out the assembly
3. Terminate cables (see connection details below)

**Note:** Do not connect two (2) cores with one (1) terminal screw. Always use one (1) screw for "IN" and one (1) screw for "OUT" to ensure line- monitoring integrity.

4. Carefully re-install the inside assembly, tighten securing screws
5. Carefully re-install the glass element and front cover, tighten securing screws

**Warning:** When switching mains power (4255-0500 only), affix a voltage warning label (not supplied) to MCP.

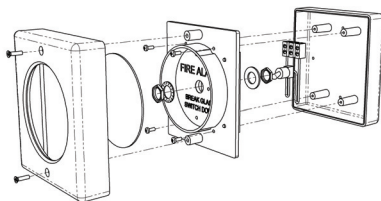

Figure 1: 4255-0500, 4255-0510 c/w Toggle Switch

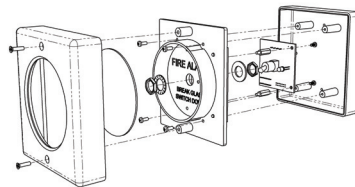

Figure 2: 4255-0600 c/w Addressable Interface

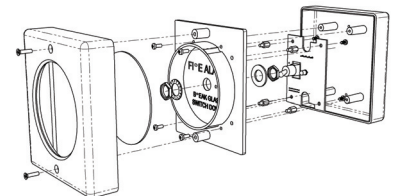
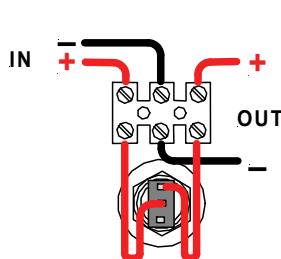
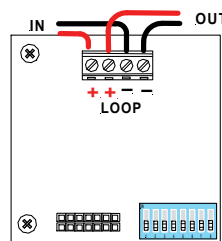

Figure 3: 4255-0700 c/w Conventional Interface



**Terminal Configuration**

- Terminal 1: Zone +ve
- Terminal 2: Zone - ve
- Terminal 3: Zone +ve



**Terminal Configuration**

- Terminal 1: Loop +ve
- Terminal 2: Loop +ve
- Terminal 3: Loop - ve
- Terminal 4: Loop - ve

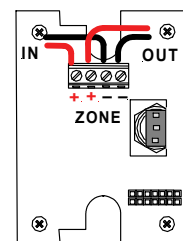

**Terminal Configuration**

- Terminal 1: Zone +ve
- Terminal 2: Zone +ve
- Terminal 3: Zone - ve
- Terminal 4: Zone - ve