

Fire detection and evacuation solutions that save lives.

Anti-Ligature Detector Mounting

Features

- Anti-Ligature Detection - suitable for secure accommodation
- Multiple Mounting Options - can be ceiling or wall mounted
- Ease of Installation - Xpert card simplifies addressing
- Various Detector Types - can be used with various Ampac detectors
- 'Lip and Ridge' Arrangement - prevents concealment of prohibited items

Description

Designed predominantly for use in areas where care of at risk persons is provided, the device provides anti-ligature protection to ensure the safety of occupants.

The unit has been designed to accept a XP95/Discovery mounting base together with a standard Ampac multicriteria detector. It can be either ceiling mounted or wall mounted using an angled mounting box.

To simplify and speed up installation and commissioning, the device address is set by simply removing 'pips' on a card. The coded XPERT card is then inserted into the side of the base where it locks into position.



Specifications

Dimensions

Wall Mounted Box 131mm H x 183mm W x 90mm D

Ceiling Mounted Box 130mm H x 130mm W x 36mm D

Anti-Ligature Breaking Weight

*Weights before Anti-Ligature detector breaks and reports 'Missing' at the Indicator

Ceiling Mounted Box
(Pulling at an angle of 0 degrees) 7.09kg

Wall Mounted Box
(Pulling at an angle of 45 degrees) 3.97kg

Item Numbers

Panels

4112-2010	Ceiling Box (For 4112-2011)
4112-2011	Base Assembly for XP95/Discovery
4112-2012	Angled Wall Box (For 4112-2011)

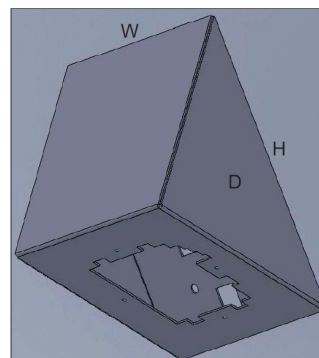

Wall Mount Box

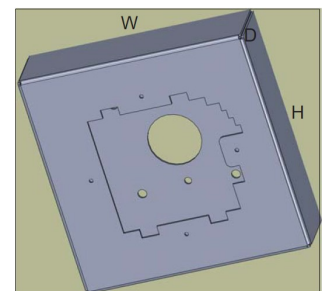

Ceiling Mount Box